

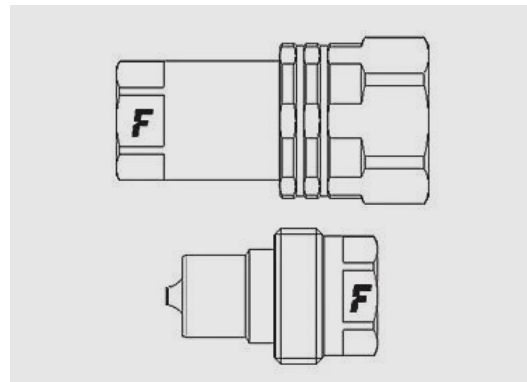

**Screw to connect standard couplings, double function sleeve.**

VV series couplings are very robust and reliable and allow to connect under residual pressure. Thanks to a double function sleeve it's also possible to connect a female part with either VV or NV male halves. Faster proprietary profile.

**Applications**



**Technical Specifications**

dash	Size		Working Pressure (MPa)	Flow Rate (l/min)	Spillage (ml)	Force to Connect (N)	Burst pressure (MPa)		
	mm	inch					Male	Female	Male + Female
04	6,3	1/4"	35	18	0,8	140	170	150	
06	10	3/8"	30	30	1,3	120	120	150	
08	12,5	1/2"	25	65	1,8	100	130	160	
12	20	3/4"	25	100	8	100	100	120	
16	25	1"	22	140	13	90	100	100	

Material	<b>Steel</b>
Seals	<b>NBR</b>
Working temperatures	<b>- 25 °C to + 125 °C</b>
Surface treatment	<b>MATE 500 (CrIII)</b>
Series Interchange	<b>FASTER</b>
Valve Type	<b>Poppet</b>
Connection	<b>Screw to Connect</b>
Disconnection	<b>Unscrew to Disconnect</b>
Connection Under Pressure	<b>Allowed Residual</b>

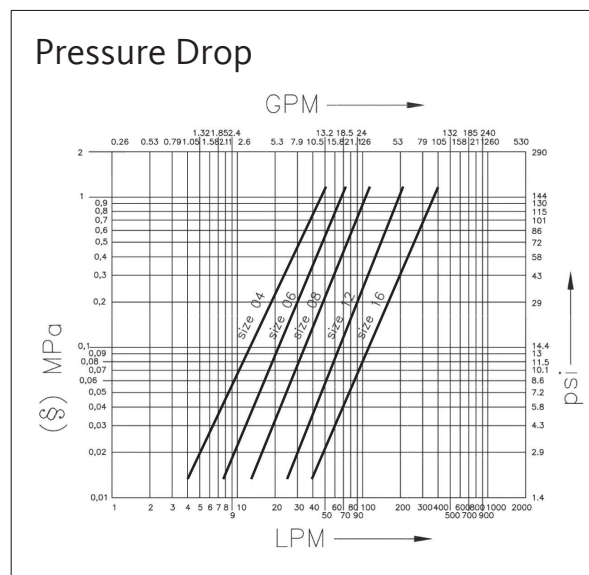

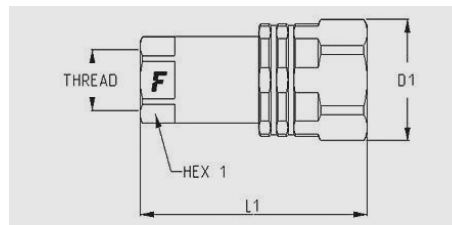

Size		Thread details			FEMALE							
inch	mm	Thread Type	Standard	Thread	Part Number	L (L1 + Thread)		D1		HEX1		
						mm	inch	mm	inch	mm	inch	
1/4"	6,3	F BSPP	ISO 1179-1	BSPP 1/4 FEMALE	VV 14 GAS F	60	2,4	30	1,2	19	0,8	
1/4"	6,3	F NPTF	ANSI B1.20.3	NPTF 1/4 FEMALE	VV 14 NPT F	60	2,4	30	1,2	19	0,8	
3/8"	10	F BSPP	ISO 1179-1	BSPP 3/8 FEMALE	VV 38 GAS F	72	2,8	38	1,5	24	0,9	
3/8"	10	F NPTF	ANSI B1.20.3	NPTF 3/8 FEMALE	VV 38 NPT F	72	2,8	38	1,5	24	0,9	
1/2"	12,5	F BSPP	ISO 1179-1	BSPP 1/2 FEMALE	VV 12 GAS F	79	3,1	42	1,7	27	1,1	
1/2"	12,5	F NPTF	ANSI B1.20.3	NPTF 1/2 FEMALE	VV 12 NPT F	79	3,1	42	1,7	27	1,1	
3/4"	20	F BSPP	ISO 1179-1	BSPP 3/4 FEMALE	VV 34 GAS F	106	4,2	55	2,2	34	1,3	
3/4"	20	F NPTF	ANSI B1.20.3	NPTF 3/4 FEMALE	VV 34 NPT F	106	4,2	55	2,2	34	1,3	
1"	25	F BSPP	ISO 1179-1	BSPP 1 FEMALE	VV 1 GAS F	124	4,9	61,5	2,4	41	1,6	
1"	25	F NPTF	ANSI B1.20.3	NPTF 1 FEMALE	VV 1 NPT F	124	4,9	61,5	2,4	41	1,6	

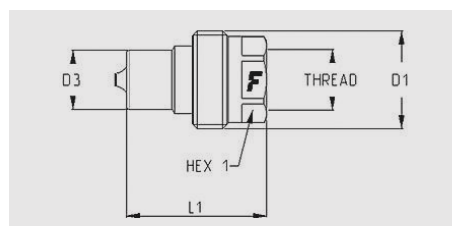

Size		Thread details			MALE									
inch	mm	Thread Type	Standard	Thread	Part Number	L (L1 + Thread)		D1		D3		HEX1		
						mm	inch	mm	inch	mm	inch	mm	inch	
1/4"	6,3	F BSPP	ISO 1179-1	BSPP 1/4 FEMALE	VV 14 GAS M	33	1,3	25,4	1	14,1	0,6	19	0,8	
1/4"	6,3	F NPTF	ANSI B1.20.3	NPTF 1/4 FEMALE	VV 14 NPT M	33	1,3	25,4	1	14,1	0,6	19	0,8	
3/8"	10	F BSPP	ISO 1179-1	BSPP 3/8 FEMALE	VV 38 GAS M	40,5	1,6	30,4	1,2	18,9	0,7	24	0,9	
3/8"	10	F NPTF	ANSI B1.20.3	NPTF 3/8 FEMALE	VV 38 NPT M	40,5	1,6	30,4	1,2	18,9	0,7	24	0,9	
1/2"	12,5	F BSPP	ISO 1179-1	BSPP 1/2 FEMALE	VV 12 GAS M	49	1,9	34	1,3	20,5	0,8	27	1,1	
1/2"	12,5	F NPTF	ANSI B1.20.3	NPTF 1/2 FEMALE	VV 12 NPT M	49	1,9	34	1,3	20,5	0,8	27	1,1	
3/4"	20	F BSPP	ISO 1179-1	BSPP 3/4 FEMALE	VV 34 GAS M	62	2,4	43,5	1,7	27,9	1,1	34	1,3	
3/4"	20	F NPTF	ANSI B1.20.3	NPTF 3/4 FEMALE	VV 34 NPT M	62	2,4	43,5	1,7	27,9	1,1	34	1,3	
1"	25	F BSPP	ISO 1179-1	BSPP 1 FEMALE	VV 1 GAS M	73	2,9	52	2,1	31,8	1,3	41	1,6	
1"	25	F NPTF	ANSI B1.20.3	NPTF 1 FEMALE	VV 1 NPT M	73	2,9	52	2,1	31,8	1,3	41	1,6	

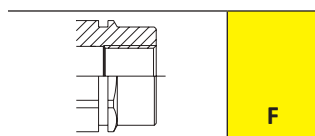

# VV accessories

## PVC dust caps



Caps suitable for FEMALE



Plugs suitable for MALE

Size			Cap Details		Size			Plug Details	
inch	mm	dash	Part number	Colour	inch	mm	dash	Part number	Colour
3/8"	10	06	TMV 38	red	3/8"	10	6	TFV 38	red

## Aluminium dust caps



Plugs suitable for FEMALE



Caps suitable for MALE

Size			Plug Details		Size			Cap Details	
inch	mm	dash	Part number	Colour	inch	mm	dash	Part number	Colour
3/8"	10	06	TMV 38 S	small chain strap	3/8"	10	06	TFV 38 S	small chain strap
3/8"	10	06	TMVM 38 SB	blue strap	3/8"	10	06	TFVM 38 SB	blue strap
3/8"	10	06	TMVM 38 SG	yellow strap	3/8"	10	06	TFVM 38 SG	yellow strap
3/8"	10	06	TMVM 38 SN	black strap	3/8"	10	06	TFVM 38 SN	black strap
3/8"	10	06	TMVM 38 SR	red strap	3/8"	10	06	TFVM 38 SR	red strap
1/2"	12,5	08	TMV 12 S		1/2"	12,5	08	TFV 12 S	
1/2"	12,5	08	TMVM 12 SR	red strap	1/2"	12,5	08	TFVM 12 SR	red strap
3/4"	20	12	TMV 34 S		3/4"	20	12	TFV 34 S	
1"	25	16	TMV 1 S		1"	25	16	TFV 1 S	

# VV accessories

## Stainless steel dust caps



Plugs suitable for FEMALE



Caps suitable for MALE

Size			Plug Details		Size			Cap Details	
inch	mm	dash	Part number	Colour	inch	mm	dash	Part number	Colour
3/8"	10	06	TMV 38 SS		1/2"	12,5	08	TFV 12 SS	
1/2"	12,5	08	TMV 12 SS		3/4"	20	12	TFV 34 SS	
3/4"	20	12	TMV 34 SS		1"	25	16	TFV 1 SS	
1"	25	16	TMV 1 SS						

## Seal Kits

### For Female



Size			Seal Details	
inch	mm	dash	Material	Part Number
1/4"	6,3	04	NBR; PTFE	SK NV 14
3/8"	10	06	NBR; PTFE	SK NV 38
1/2"	12,5	08	NBR; PTFE	SK NV 12
3/4"	20	12	NBR; PTFE	SK NV 34
1"	25	16	NBR; PTFE	SK NV 1

Every seals kit is composed of 5 or 10 pcs.