

# VA



## Screw to connect couplings for braking systems.

VA couplings are commonly used in Agriculture Market for braking systems and consequently very similar to VF braking valves. Characterized by screw-to-connect sleeve, their interchangeability is based on market driven standards.



## Applications

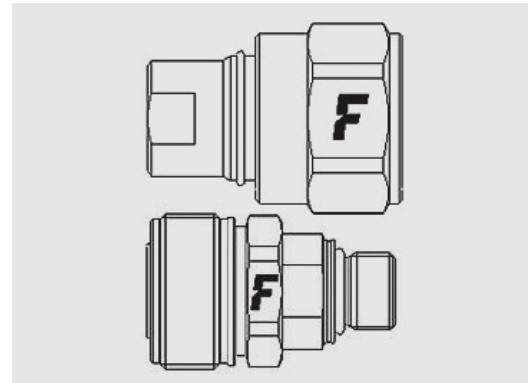

## Technical Specifications

dash	Size		Working Pressure (MPa)	Flow Rate (l/min)	Spillage (ml)	Force to Connect (N)	Burst pressure (MPa)		
	mm	inch					Male	Female	Male + Female
06	10	3/8"	22	40	0,05	90	90	110	

Material	<b>Steel</b>
Seals	<b>NBR</b>
Working temperatures	<b>- 25 °C to + 125 °C</b>
Surface treatment	<b>MATE 500 (CrIII)</b>
Series Interchange	<b>MARKET</b>
Valve Type	<b>Flat</b>
Connection	<b>Screw to Connect</b>
Disconnection	<b>Unscrew to Disconnect</b>
Connection Under Pressure	<b>Not Allowed</b>

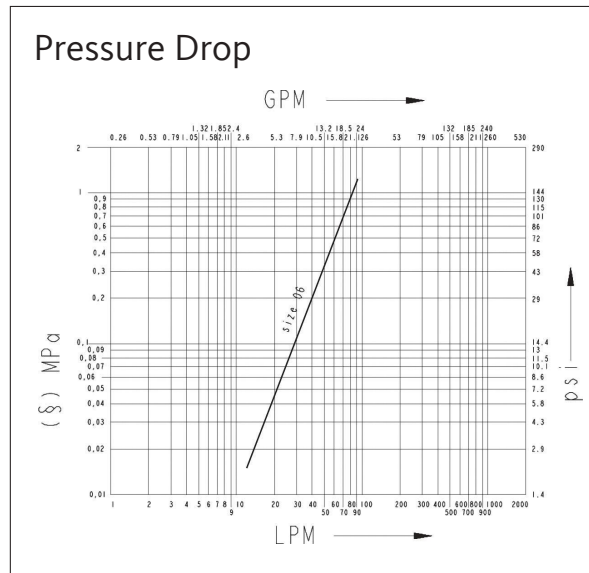

VA

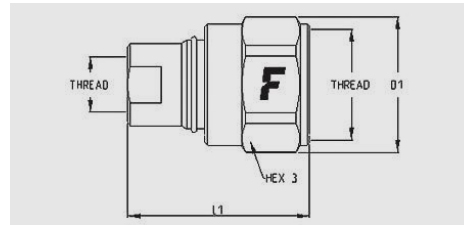

Size		Thread details			FEMALE						
inch	mm	Thread Type	Standard	Thread	Part Number	L (L1 + Thread)		D1		HEX1	
						mm	inch	mm	inch	mm	inch
3/8"	10	0/ METRIC	ISO 6149-1	M18x1,5 FEMALE ORB	VAN0/1815 F	60	2,36	44	1,73	32	1,26

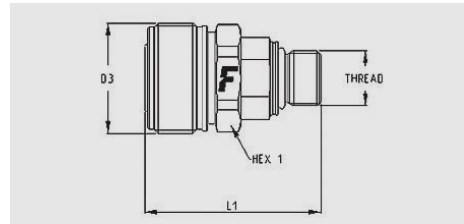

Size		Thread details			MALE								
inch	mm	Thread Type	Standard	Thread	Part Number	L (L1 + Thread)		D1		D3		HEX1	
						mm	inch	mm	inch	mm	inch	mm	inch
3/8"	10	05/ METRIC	ISO 8434-1-L	M22x1,5 MALE BULKHEAD 15L	VA 5/2215 M	59	2,32	36	1,42	36	1,42	32	1,26
3/8"	10	09/ METRIC	ISO 8434-1-L	M18x1,5 MALE BULKHEAD 12L	VA 9/1815 M	53	2,09	36	1,42	36	1,42	32	1,26

## Accessories

### PVC dust caps



Caps suitable for MALE

Size			Cap Details	
inch	mm	dash	Part number	Colour
3/8"	10	06	TFVA	yellow
3/8"	10	06	TFVA N	black

