

RF



Screw to connect couplings for air conditioning & refrigeration application.

This range of couplings has been specifically designed for air conditioning and refrigeration systems. Interchangeability according to market driven standards. Available in several versions in steel, brass and with copper sweat braze adaptor.



Applications

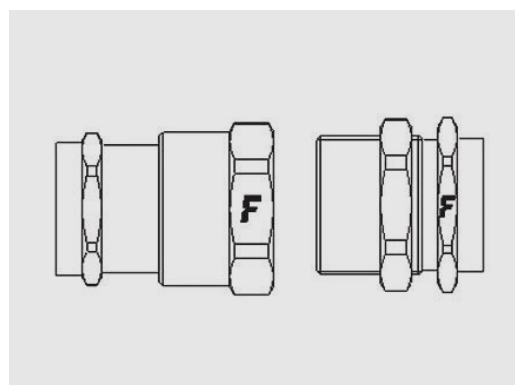

Technical Specifications

| dash | Size | | Working Pressure (MPa) | Flow Rate (l/min) | Spillage (ml) | Force to Connect (N) | Burst pressure (MPa) | | |
|------|------|------|------------------------|-------------------|---------------|----------------------|----------------------|--------|---------------|
| | mm | inch | | | | | Male | Female | Male + Female |
| 04 | 6,3 | 1/4" | 3,5 | | | | 53 | 10,5 | 100 |
| 06 | 10 | 3/8" | 6 | | | | 21 | 19 | 26 |
| 08 | 12,5 | 1/2" | 5 | | | | 26 | 15 | 25 |
| 12 | 20 | 3/4" | 5 | | | | 21 | 15 | 19 |
| 16 | 25 | 1" | 5 | | | | 13 | 15 | 15 |

| | |
|---------------------------|------------------------------|
| Material | Brass; Steel |
| Seals | CR |
| Working temperatures | - 40 °C to + 120 °C |
| Surface treatment | MATE 500 (CrIII) |
| Series Interchange | MARKET |
| Valve Type | Flat |
| Connection | Screw to Connect |
| Disconnection | Unscrew to Disconnect |
| Connection Under Pressure | Allowed Residual |

Pressure Drop



RF

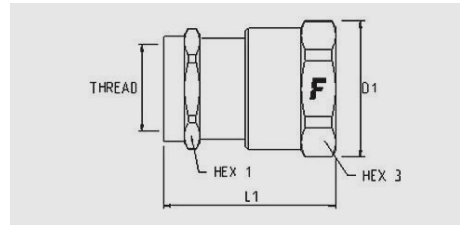

| Size | | Thread details | | | FEMALE | | | | | | |
|------|------|----------------|------------|----------------------------|-----------------|-----------------|------|----|------|------|------|
| inch | mm | Thread Type | Standard | Thread | Part Number | L (L1 + Thread) | | D1 | | HEX1 | |
| | | | | | | mm | inch | mm | inch | mm | inch |
| 1/4" | 6,3 | 0/ SAE | ASME B1.1 | 1/2" -20 UNF FEMALE ORB | RF 04 F N | 28 | 1,1 | 21 | 0,8 | 16 | 0,6 |
| 3/8" | 10 | 0/ METRIC | ISO 6149-1 | M18x1,5 FEMALE ORB | RF 06 F 5 N | 34,9 | 1,4 | 27 | 1,1 | 22 | 0,9 |
| 3/8" | 10 | 0/ METRIC | ISO 6149-1 | M18x1,5 FEMALE ORB | RF 06 F N | 34,9 | 1,4 | 27 | 1,1 | 22 | 0,9 |
| 3/8" | 10 | COPPER SWEAT | n.a. | 3/8" | RF 06 CS095 F5N | 76 | 3 | 27 | 1,1 | 22 | 0,9 |
| 1/2" | 12,5 | 0/ SAE | ASME B1.1 | 7/8" -20 UNEF FEMALE ORB | RF 08 F N | 46,5 | 1,8 | 34 | 1,3 | 27 | 1,1 |
| 1/2" | 12,5 | COPPER SWEAT | | 1/2" | RF 08 CS125 F5N | 107 | 4,2 | 34 | 1,3 | 27 | 1,1 |
| 1/2" | 12,5 | COPPER SWEAT | | 5/8" | RF 08 CS160 F5N | 107 | 4,2 | 34 | 1,3 | 27 | 1,1 |
| 1/2" | 12,5 | COPPER SWEAT | | 3/8" | RF 08 CS095 F5N | 111 | 4,4 | 34 | 1,3 | 27 | 1,1 |
| 3/4" | 20 | 0/ SAE | ASME B1.1 | 1-1/4" -18 UNEF FEMALE ORB | RF 12 F N | 55,5 | 2,2 | 45 | 1,8 | 36 | 1,4 |
| 3/4" | 20 | COPPER SWEAT | | 5/8" | RF 12 CS160 F5N | 131 | 5,2 | 45 | 1,8 | 36 | 1,4 |
| 3/4" | 20 | COPPER SWEAT | | 3/4" | RF 12 CS190 F5N | 131 | 5,2 | 45 | 1,8 | 36 | 1,4 |
| 3/4" | 20 | COPPER SWEAT | | 7/8" | RF 12 CS220 F5N | 131 | 5,2 | 45 | 1,8 | 36 | 1,4 |
| 1" | 25 | - | | - | RF 16 F N | 61,5 | 2,4 | 55 | 2,2 | 46 | 1,8 |
| 1" | 25 | COPPER SWEAT | | 7/8" | RF 16 CS220 F5N | 146,5 | 5,8 | 55 | 2,2 | 46 | 1,8 |
| 1" | 25 | COPPER SWEAT | | 1" | RF 16 CS255 F5N | 146,5 | 5,8 | 55 | 2,2 | 46 | 1,8 |

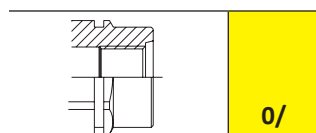

RF

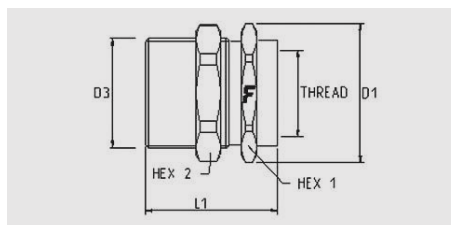

| Size | | Thread details | | | MALE | | | | | | | | | |
|------|------|----------------|------------|--------------------|-----------------|-----------------|------|----|------|------|------|------|------|--|
| inch | mm | Thread Type | Standard | Thread | Part Number | L (L1 + Thread) | | D1 | | D3 | | HEX1 | | |
| | | | | | | mm | inch | mm | inch | mm | inch | mm | inch | |
| 3/8" | 10 | 0/ METRIC | ISO 6149-1 | M18x1,5 FEMALE ORB | RF 06 M 5 N | 26,5 | 1 | 24 | 0,9 | 20 | 0,8 | 22 | 0,9 | |
| 3/8" | 10 | 0/ METRIC | ISO 6149-1 | M18x1,5 FEMALE ORB | RF 06 M N | 27,5 | 1,1 | 27 | 1,1 | 20 | 0,8 | 22 | 0,9 | |
| 3/8" | 10 | 0/ METRIC | ISO 6149-1 | M20x1,5 | RF 06 M N | 27,5 | 1,1 | 27 | 1,1 | 20 | 0,8 | 22 | 0,9 | |
| 3/8" | 10 | COPPER SWEAT | | 1/4" | RF 06 CS065 M5N | 67,5 | 2,7 | 25 | 1 | 20 | 0,8 | 22 | 0,9 | |
| 3/8" | 10 | COPPER SWEAT | | 3/8" | RF 06 CS095 M5N | 67,5 | 2,7 | 25 | 1 | 20 | 0,8 | 22 | 0,9 | |
| 1/2" | 12,5 | 0/ SAE | ASME B1.1 | 1"-20 UNEF | RF 08 M N | 38,5 | 1,5 | 32 | 1,3 | 25,4 | 1 | 28 | 1,1 | |
| 1/2" | 12,5 | COPPER SWEAT | | 1/2" | RF 08 CS125 M5N | 96 | 3,8 | 32 | 1,3 | 25,4 | 1 | 28 | 1,1 | |
| 1/2" | 12,5 | COPPER SWEAT | | 3/8" | RF 08 CS095 M5N | 100 | 3,9 | 32 | 1,3 | 25,4 | 1 | 28 | 1,1 | |
| 1/2" | 12,5 | COPPER SWEAT | | 1/2" | RFR08 TS125LM5N | 159,5 | 6,3 | 32 | 1,3 | 25,4 | 1 | 28 | 1,1 | |
| 3/4" | 20 | 0/ SAE | ASME B1.1 | 1"-7/16"-16 UN | RF 12 M N | 73,5 | 2,9 | 46 | 1,8 | 36,5 | 1,4 | 41 | 1,6 | |
| 3/4" | 20 | COPPER SWEAT | | 5/8" | RF 12 CS160 M5N | 118,5 | 4,7 | 46 | 1,8 | 36,5 | 1,4 | 41 | 1,6 | |
| 3/4" | 20 | COPPER SWEAT | | 3/4" | RF 12 CS190 M5N | 118,5 | 4,7 | 46 | 1,8 | 36,5 | 1,4 | 41 | 1,6 | |
| 3/4" | 20 | COPPER SWEAT | | 7/8" | RF 12 CS220 M5N | 118,5 | 4,7 | 46 | 1,8 | 36,5 | 1,4 | 41 | 1,6 | |
| 1" | 25 | | | | RF 16 M N | 81,5 | 3,2 | 53 | 2,1 | 44,5 | 1,8 | 48 | 1,9 | |
| 1" | 25 | COPPER SWEAT | | 7/8" | RF 16 CS220 M5N | 130,8 | 5,2 | 53 | 2,1 | 44,5 | 1,8 | 48 | 1,9 | |
| 1" | 25 | COPPER SWEAT | | 1" | RF 16 CS255 M5N | 130,8 | 5,2 | 53 | 2,1 | 44,5 | 1,8 | 48 | 1,9 | |

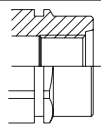

0/

RF accessories

Aluminium dust caps



Plugs suitable for FEMALE



Caps suitable for MALE

| Size | | | Plug Details | | Size | | | Cap Details | |
|------|------|------|--------------|--------|------|------|------|-------------|--------|
| inch | mm | dash | Part number | Colour | inch | mm | dash | Part number | Colour |
| 1/4" | 6,3 | 04 | TMRF 04 S N | | 1/4" | 6,3 | 04 | TFRF 04 S | |
| 3/8" | 10 | 06 | TMRF 06 S N | | 3/8" | 10 | 06 | TFRF 06 S N | |
| 1/2" | 12,5 | 08 | TMRF 08 S N | | 1/2" | 12,5 | 08 | TFRF 08 S N | |
| 3/4" | 20 | 12 | TMRF 12 S N | | 3/4" | 20 | 12 | TFRF 12 S N | |
| 1" | 25 | 16 | TMRF 16 S N | | 1" | 25 | 16 | TFRF 16 S N | |