

# OGV



## Screw to connect couplings for oil & gas application, market interchange.

Standard screw-to-connect coupling suitable for Oil & Gas applications. Robust sleeve design, poppet valve and ACME connection thread.



## Applications

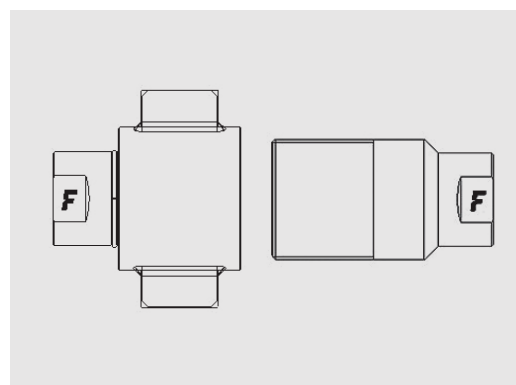

## Technical Specifications

dash	Size		Working Pressure (MPa)	Flow Rate (l/min)	Spillage (ml)	Force to Connect (N)	Burst pressure (MPa)		
	mm	inch					Male	Female	Male + Female
12	20	3/4"	35	120	8	168	160	165	
16	25	1"	35	230	18	165	165	172	
20	31,5	1-1/4"	35	320	21	180	200	178	
24	37,5	1-1/2"	35	330	41	160	176	170	
32	50	2"	35	570	85	125	130	125	

Material	<b>Steel</b>
Seals	<b>NBR; PUR</b>
Working temperatures	<b>- 25 °C to + 100 °C</b>
Surface treatment	<b>MATE 500 (CrIII)</b>
Series Interchange	<b>MARKET</b>
Valve Type	<b>Poppet</b>
Connection	<b>Screw to Connect</b>
Disconnection	<b>Unscrew to Disconnect</b>
Connection Under Pressure	<b>Allowed Residual</b>

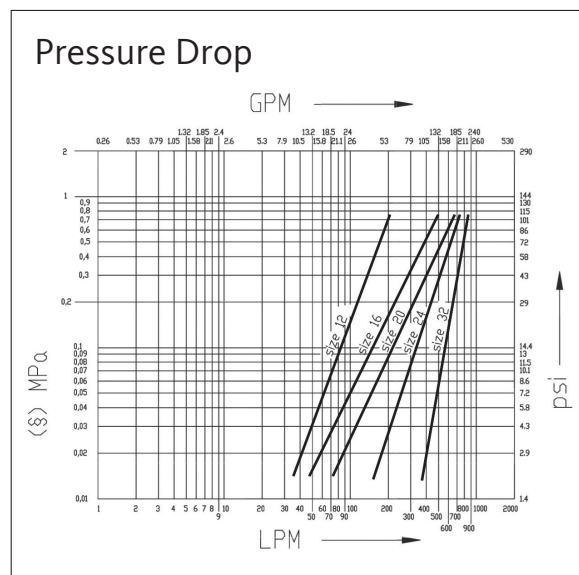

OGV

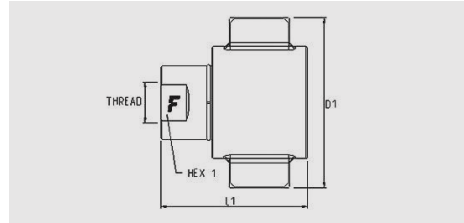

Size		Thread details			FEMALE						
inch	mm	Thread Type	Standard	Thread	Part Number	L (L1 + Thread)		D1		HEX1	
						mm	inch	mm	inch	mm	inch
3/4"	20	F NPSF	ANSI B1.20.3	NPSF 3/4 FEMALE	OGV12 34NPS F	72,2	2,8	55	2,2	32	1,3
1"	25	F NPSF	ANSI B1.20.3	NPSF 1 FEMALE	OGV16 1NPS F	87,6	3,5	105,5	4,2	41	1,6
1-1/4"	31,5	F NPTF	ANSI B1.20.3	NPTF 1-1/4 FEMALE	OGV20 114NPT F	111,9	4,4	118,2	4,7	50	2
1-1/2"	37,5	F NPTF	ANSI B1.20.3	NPTF 1-1/2 FEMALE	OGV24 112NPT F	127,1	5	147	5,8	55	2,2
2"	50	F NPTF	ANSI B1.20.3	NPTF 2 FEMALE	OGV32 2NPT F	154,2	6,1	170	6,7	75	3

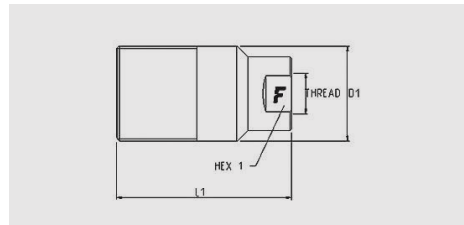

Size		Thread details			MALE								
inch	mm	Thread Type	Standard	Thread	Part Number	L (L1 + Thread)		D1		D3		HEX1	
						mm	inch	mm	inch	mm	inch	mm	inch
3/4"	20	F NPSF	ANSI B1.20.3	NPSF 3/4 FEMALE	OGV12 34NPS M	83,1	3,3	44,3	1,7			32	1,3
1"	25	F NPSF	ANSI B1.20.3	NPSF 1 FEMALE	OGV16 1NPS M	106	4,2	57,1	2,3			41	1,6
1-1/4"	31,5	F NPTF	ANSI B1.20.3	NPTF 1-1/4 FEMALE	OGV20 114NPT M	136,5	5,4	66,7	2,6			50	2
1-1/2"	37,5	F NPTF	ANSI B1.20.3	NPTF 1-1/2 FEMALE	OGV24 112NPT M	151,7	6	82,5	3,3			55	2,2
2"	50	F NPTF	ANSI B1.20.3	NPTF 2 FEMALE	OGV32 2NPT M	179,1	7,1	101,6	4			75	3

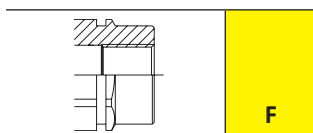

# OGV Accessories

## Aluminium dust caps



Plugs suitable for FEMALE



Caps suitable for MALE

Size			Plug Details		Size			Cap Details	
inch	mm	dash	Part number	Colour	inch	mm	dash	Part number	Colour
3/4"	20	12	TM OGV12 S		3/4"	20	12	TF OGV12 S	
1"	25	16	TM OGV16 S		1"	25	16	TF OGV16 S	
1-1/4"	31,5	20	TM OGV20 S		1-1/4"	31,5	20	TF OGV20 S	
1-1/2"	37,5	24	TM OGV24 S		1-1/2"	37,5	24	TF OGV24 S	
2"	50	32	TM OGV32 S		2"	50	32	TF OGV32 S	