

ANV



Standard couplings for agriculture, ISO 7241-A interchange.

Standard couplings for agriculture applications. Complete range of sizes from 1/4" to 2" (with BSP, NPT or SAE female threads available). ISO 7241 part A interchange.

Applications

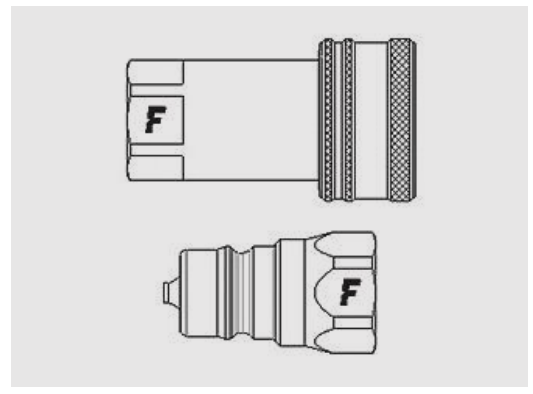

Technical Specifications

dash	Size		Working Pressure (MPa)	Flow Rate (l/min)	Spillage (ml)	Force to Connect (N)	Burst pressure (MPa)		
	mm	inch					Male	Female	Male + Female
04	6,3	1/4"	50	8	0,5	45	200	200	200
06	10	3/8"	30	30	1,1	80	120	140	160
08	12,5	1/2"	30	75	1,8	80	120	120	130
12	20	3/4"	30	180	8	150	120	120	120
16	25	1"	25	270	10	150	100	100	100
20	31,5	1-1/4"	25	330	20	170	100	100	100
24	37,5	1-1/2"	20	450	32	255	80	80	80
32	50	2"	15	900	85	440	60	60	60

Material	Steel
Seals	NBR
Working temperatures	- 25 °C to + 125 °C
Surface treatment	MATE 500 (CrIII)
Series Interchange	ISO 7241-A
Valve Type	Poppet
Connection	Sleeve Retraction
Disconnection	Sleeve Retraction
Connection Under Pressure	Not Allowed

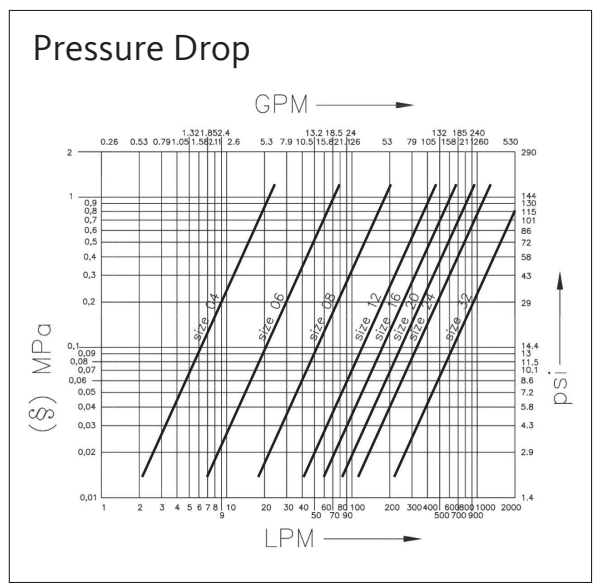

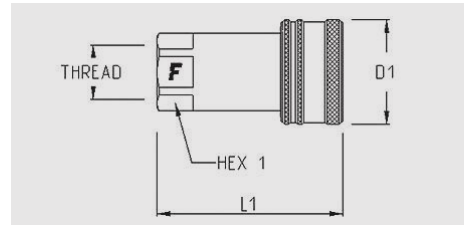

Size		Thread details			FEMALE						
inch	mm	Thread Type	Standard	Thread	Part Number	L (L1 + Thread)		D1		HEX1	
						mm	inch	mm	inch	mm	inch
1/4"	6,3	O/ METRIC	ISO 6149-1	M14x1,5 FEMALE ORB	ANV0/1415 F	47,7	1,88	25	0,98	19	0,75
1/4"	6,3	F BSPP	ISO 1179-1	BSPP 1/4 FEMALE	ANV 14 GAS F	47,2	1,86	25	0,98	19	0,75
1/4"	6,3	F JPT	UNI EN 10226-2	RC 1/4 FEMALE (JPT)	ANV 14 JPT F	47,2	1,86	25	0,98	19	0,75
1/4"	6,3	F NPTF	ANSI B1.20.3	NPTF 1/4 FEMALE	ANV 14 NPT F	48	1,89	25	0,98	19	0,75
3/8"	10	F BSPP	ISO 1179-1	BSPP 3/8 FEMALE	ANV 38 GAS F	57	2,24	32	1,26	22	0,87
3/8"	10	F JPT	UNI EN 10226-2	RC 3/8 FEMALE (JPT)	ANV 38 JPT F	57,2	2,25	32	1,26	22	0,87
3/8"	10	F METRIC	ISO 9974-1	M18x1,5 FEMALE	ANV 1815 F	57	2,24	32	1,26	22	0,87
3/8"	10	F NPTF	ANSI B1.20.3	NPTF 3/8 FEMALE	ANV 38 NPT F	57	2,24	32	1,26	22	0,87
3/4"	20	O/ SAE	ISO 11926-1	1-1/16"-12 UN FEMALE ORB	ANV 34-34SAE F	82,5	3,25	48	1,89	34	1,34
3/4"	20	F BSPP	ISO 1179-1	BSPP 3/4 FEMALE	ANV 34 GAS F	82,5	3,25	48	1,89	34	1,34
3/4"	20	F JPT	UNI EN 10226-2	RC 3/4 FEMALE (JPT)	ANV 34 JPT F	82,5	3,25	48	1,89	34	1,34
3/4"	20	F NPTF	ANSI B1.20.3	NPTF 3/4 FEMALE	ANV 34 NPT F	82,5	3,25	48	1,89	34	1,34
1"	25	O/ SAE	ISO 11926-1	1-5/16"-12 UN FEMALE ORB	ANV 1-1 SAE F	100	3,94	56	2,2	41	1,61
1"	25	F BSPP	ISO 1179-1	BSPP 1 FEMALE	ANV 1 GAS F	100	3,94	56	2,2	41	1,61
1"	25	F JPT	UNI EN 10226-2	RC 1 FEMALE (JPT)	ANV 1 JPT F	100	3,94	56	2,2	41	1,61
1"	25	F NPTF	ANSI B1.20.3	NPTF 1 FEMALE	ANV 1 NPT F	100	3,94	56	2,2	41	1,61
1-1/4"	31,5	F BSPP	ISO 1179-1	BSPP 1-1/4 FEMALE	ANV114 GAS F	116	4,57	70	2,76	50	1,97
1-1/4"	31,5	F NPTF	ANSI B1.20.3	NPTF 1-1/4 FEMALE	ANV114 NPT F	116	4,57	70	2,76	50	1,97
1-1/2"	37,5	F BSPP	ISO 1179-1	BSPP 1-1/2 FEMALE	ANV112 GAS F	132,5	5,22	84	3,31	60	2,36
2"	50	F BSPP	ISO 1179-1	BSPP 2 FEMALE	ANV 2 GAS F	161	6,34	100	3,94	75	2,95
2"	50	F NPTF	ANSI B1.20.3	NPTF 2 FEMALE	ANV 2 NPT F	161	6,34	100	3,94	75	2,95

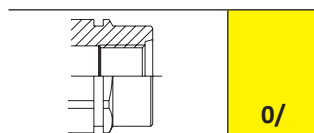
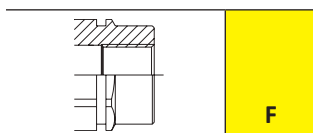

ANV

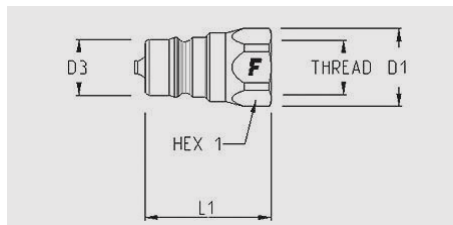

Size		Thread details			MALE									
inch	mm	Thread Type	Standard	Thread	Part Number	L (L1 + Thread)		D1		D3		HEX1		
						mm	inch	mm	inch	mm	inch	mm	inch	
1/4"	6,3	O/ METRIC	ISO 6149-1	M14x1,5 FEMALE ORB	ANV0/1415 M	39	1,54	21	0,83	11,8	0,46	19	0,75	
1/4"	6,3	O/ SAE	ISO 11926-1	9/16"-18 UNF FEMALE ORB	ANV 14-38SAE M	40,2	1,58	21	0,83	11,8	0,46	19	0,75	
1/4"	6,3	F BSPP	ISO 1179-1	BSPP 1/4 FEMALE	ANV 14 GAS M	38,6	1,52	21	0,83	11,8	0,46	19	0,75	
1/4"	6,3	F JPT	UNI EN 10226-2	RC 1/4 FEMALE (JPT)	ANV 14 JPT M	38,6	1,52	21	0,83	11,8	0,46	19	0,75	
1/4"	6,3	F NPTF	ANSI B1.20.3	NPTF 1/4 FEMALE	ANV 14 NPT M	38,6	1,52	21	0,83	11,8	0,46	19	0,75	
3/8"	10	F BSPP	ISO 1179-1	BSPP 3/8 FEMALE	ANV 38 GAS M	39	1,54	24	0,94	17,2	0,68	22	0,87	
3/8"	10	F JPT	UNI EN 10226-2	RC 3/8 FEMALE (JPT)	ANV 38 JPT M	39	1,54	24	0,94	17,2	0,68	22	0,87	
3/8"	10	F METRIC	ISO 9974-1	M18x1,5 FEMALE	ANV 1815 M	39	1,54	24	0,94	17,2	0,68	22	0,87	
3/8"	10	F NPTF	ANSI B1.20.3	NPTF 3/8 FEMALE	ANV 38 NPT M	39	1,54	24	0,94	17,2	0,68	22	0,87	
3/4"	20	O/ METRIC	ISO 6149-1	M26x1,5 FEMALE ORB	ANV0/2615 M	53	2,09	38	1,5	29	1,14	34	1,34	
3/4"	20	O/ SAE	ISO 11926-1	1-1/16"-12 UN FEMALE ORB	ANV 34-34SAE M	55	2,17	38	1,5	29	1,14	34	1,34	
3/4"	20	F BSPP	ISO 1179-1	BSPP 3/4 FEMALE	ANV 34 GAS M	55	2,17	38	1,5	29	1,14	34	1,34	
3/4"	20	F JPT	UNI EN 10226-2	RC 3/4 FEMALE (JPT)	ANV 34 JPT M	55	2,17	38	1,5	29	1,14	34	1,34	
3/4"	20	F NPTF	ANSI B1.20.3	NPTF 3/4 FEMALE	ANV 34 NPT M	55	2,17	38	1,5	29	1,14	34	1,34	
1"	25	F BSPP	ISO 1179-1	BSPP 1 FEMALE	ANV 1 GAS M	66	2,6	45	1,8	34,3	1,35	41	1,61	
1"	25	F JPT	UNI EN 10226-2	RC 1 FEMALE (JPT)	ANV 1 JPT M	66	2,6	45	1,77	34,3	1,35	41	1,61	
1"	25	F NPTF	ANSI B1.20.3	NPTF 1 FEMALE	ANV 1 NPT M	66	2,6	45	1,77	34,3	1,35	41	1,61	
1-1/4"	31,5	F BSPP	ISO 1179-1	BSPP 1-1/4 FEMALE	ANV114 GAS M	73	2,87	55,5	2,19	44,9	1,77	50	1,97	
1-1/4"	31,5	F NPTF	ANSI B1.20.3	NPTF 1-1/4 FEMALE	ANV114 NPT M	73	2,87	55,5	2,19	44,9	1,77	50	1,97	
1-1/2"	37,5	F BSPP	ISO 1179-1	BSPP 1-1/2 FEMALE	ANV112 GAS M	83	3,27	66	2,6	55	2,17	60	2,36	
2"	50	F BSPP	ISO 1179-1	BSPP 2 FEMALE	ANV 2 GAS M	100	3,94	85	3,35	65	2,56	75	2,95	
2"	50	F NPTF	ANSI B1.20.3	NPTF 2 FEMALE	ANV 2 NPT M	100	3,94	85	3,35	65	2,56	75	2,95	

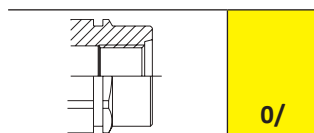
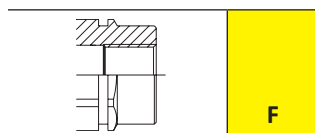

ANV Accessories

PVC dust caps



Plugs suitable for FEMALE



Caps suitable for MALE

Size			Plug Details		Size			Cap Details	
inch	mm	dash	Part number	Colour	inch	mm	dash	Part number	Colour
1/4"	6,3	04	TMA 14	yellow	1/4"	6,3	04	TFA 14	yellow
1/4"	6,3	04	TMA 14 A	orange	1/4"	6,3	04	TFA 14 V	green
1/4"	6,3	04	TMA 14 R	red	3/8"	10	06	TFA 38	yellow
3/8"	10	06	TMA 38	yellow	3/8"	10	06	TFA 38 A	orange
3/8"	10	06	TMA 38 A	orange	3/8"	10	06	TFA 38 B	blue
3/8"	10	06	TMA 38 B	blue	3/8"	10	06	TFA 38 N	black
3/8"	10	06	TMA 38 N	black	3/8"	10	06	TFA 38 R	red
3/8"	10	06	TMA 38 R	red	3/8"	10	06	TFA 38 V	green
3/8"	10	06	TMA 38 V	green	3/4"	20	12	TFA 34	yellow
3/4"	20	12	TMA 34	yellow	3/4"	20	12	TFA 34 B	blue
3/4"	20	12	TMA 34 N	black	3/4"	20	12	TFA 34 N	black
3/4"	20	12	TMA 34 R	red	3/4"	20	12	TFA 34 R	red
1"	25	16	TMA 1	yellow	1"	25	16	TFA 1	yellow
1"	25	16	TMA 1 N	black	1"	25	16	TFA 1 N	black
1"	25	16	TMA 1 R	red	1"	25	16	TFA 1 R	red

Seal Kits



For Female

Size			Seal Details	
inch	mm	dash	Material	Part Number
1/4"	6,3	04	NBR; PTFE	SK ANV 14
3/8"	10	06	NBR; PTFE	SK ANV 38
3/4"	20	12	NBR; PTFE	SK ANV 34
1"	25	16	NBR; PTFE	SK ANV 1
1-1/4"	31,5	20	NBR; PTFE	SK ANV 114
1-1/2"	37,5	24	NBR	SK ANV 112
2"	50	32	NBR	SK ANV 2

Every seals kit is composed of 5 or 10 pcs.