

2NV



Standard couplings, poppet valve, shielded.

Standard coupling for agriculture application, with poppet valve and shielded valve-guide to prevent accidental disconnections caused by sudden backflow. ISO 7241-1 part A interchange.



Applications

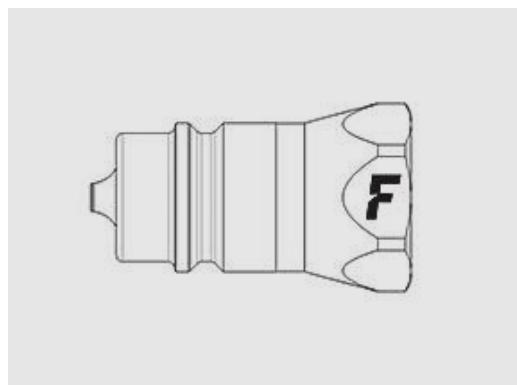

Technical Specifications

dash	Size		Working Pressure (MPa)	Flow Rate (l/min)	Spillage (ml)	Force to Connect (N)	Burst pressure (MPa)		
	mm	inch					Male	Female	Male + Female
08	12,5	1/2"	25	60	1,8	80	100		130

Material	Steel
Seals	NBR
Working temperatures	- 25 °C to + 125 °C
Surface treatment	MATE 500 (CrIII)
Series Interchange	ISO 7241-A
Valve Type	Poppet
Connection	
Disconnection	
Connection Under Pressure	Not Allowed

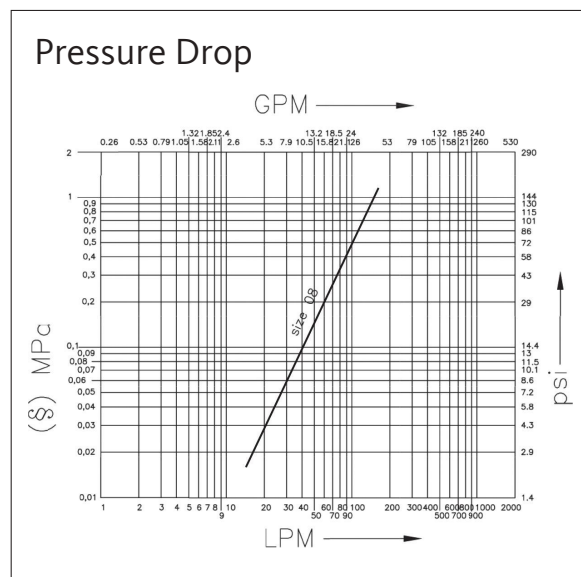

2NV

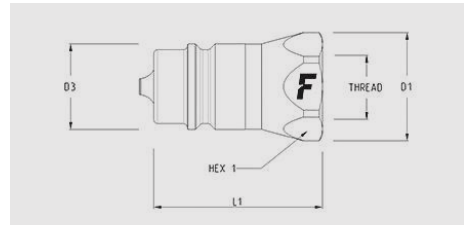

Size		Thread details			MALE									
inch	mm	Thread Type	Standard	Thread	Part Number	L (L1 + Thread)		D1		D3		HEX1		
						mm	inch	mm	inch	mm	inch	mm	inch	
1/2"	12,5	O/ BSPP	BS 5380	BSPP 1/2 FEMALE ORB	2NV0/12 GAS M	47	1,85	30	1,18	20,5	0,81	27	1,06	
1/2"	12,5	O/ SAE	ISO 11926-1	3/4"-16 UNF FEMALE ORB	2NV 12-12SAE M	47	1,85	30	1,18	20,5	0,81	27	1,06	
1/2"	12,5	O/ SAE	ISO 11926-1	7/8"-14 UNF FEMALE ORB	2NV 12-58SAE M	52,5	2,07	30	1,18	20,5	0,81	27	1,06	
1/2"	12,5	F BSPP	ISO 1179-1	BSPP 1/2 FEMALE	2NV 12 GAS M	47	1,85	30	1,18	20,5	0,81	27	1,06	
1/2"	12,5	F NPTF	ANSI B1.20.3	NPTF 1/2 FEMALE	2NV 12 NPT M	47	1,85	30	1,18	20,5	0,81	27	1,06	

Accessories

PVC dust caps



Caps suitable for MALE

Size			Cap Details	
inch	mm	dash	Part number	Colour
1/2"	12,5	08	TF 12	blue
1/2"	12,5	08	TF 12 A	orange
1/2"	12,5	08	TF 12 G	yellow
1/2"	12,5	08	TF 12 GR	grey
1/2"	12,5	08	TF 12 M	brown
1/2"	12,5	08	TF 12 N	black
1/2"	12,5	08	TF 12 R	red
1/2"	12,5	08	TF 12 V	green

Aluminium dust caps



Caps suitable for MALE

Size			Cap Details	
inch	mm	dash	Part number	Colour
1/2"	12,5	08	TF 12 S	

